

Window No.	Structural Opening (mm)
2	1099x1033
3	1014x984
4	971x1562
5	861x1023
6	997x635

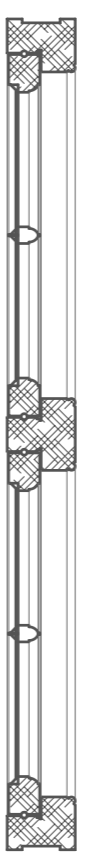

CASEMENT WINDOW [2]

Scale 1 : 10

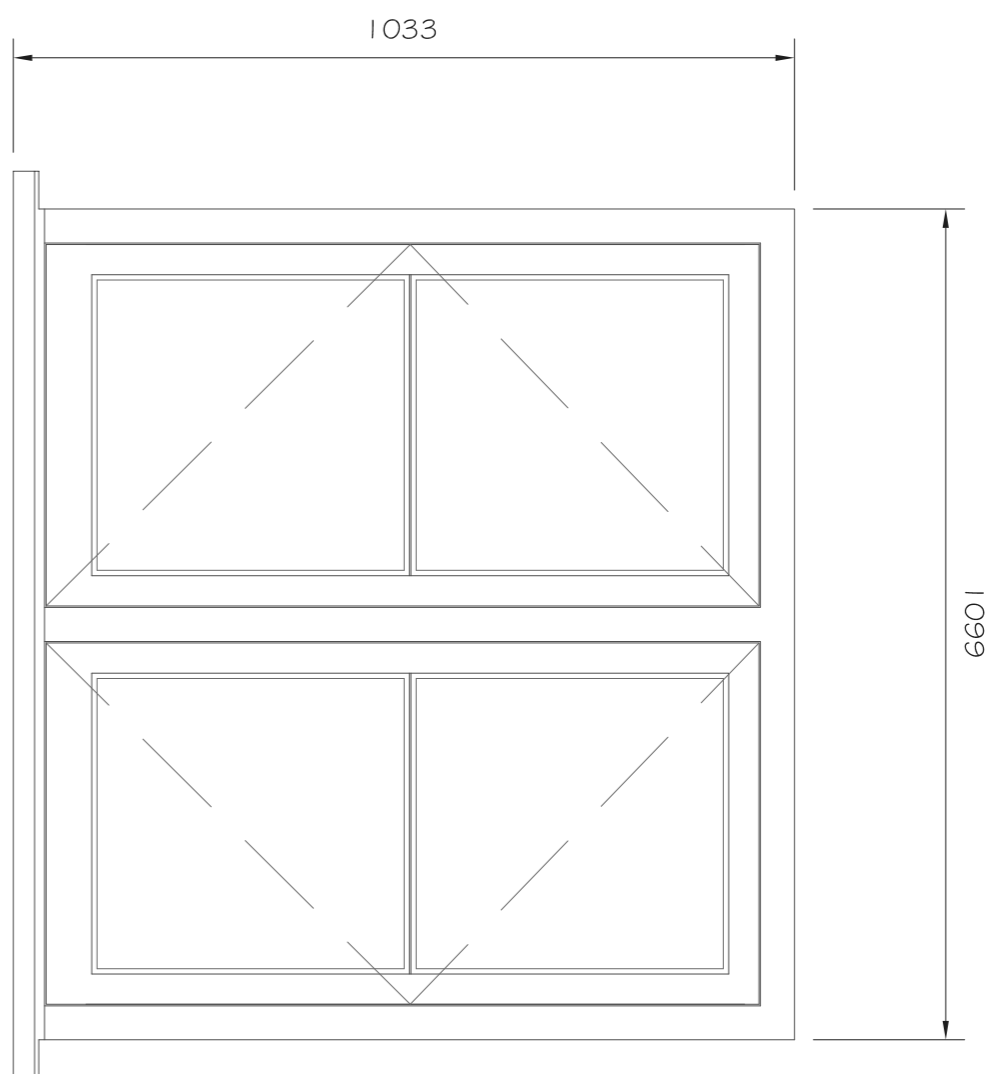
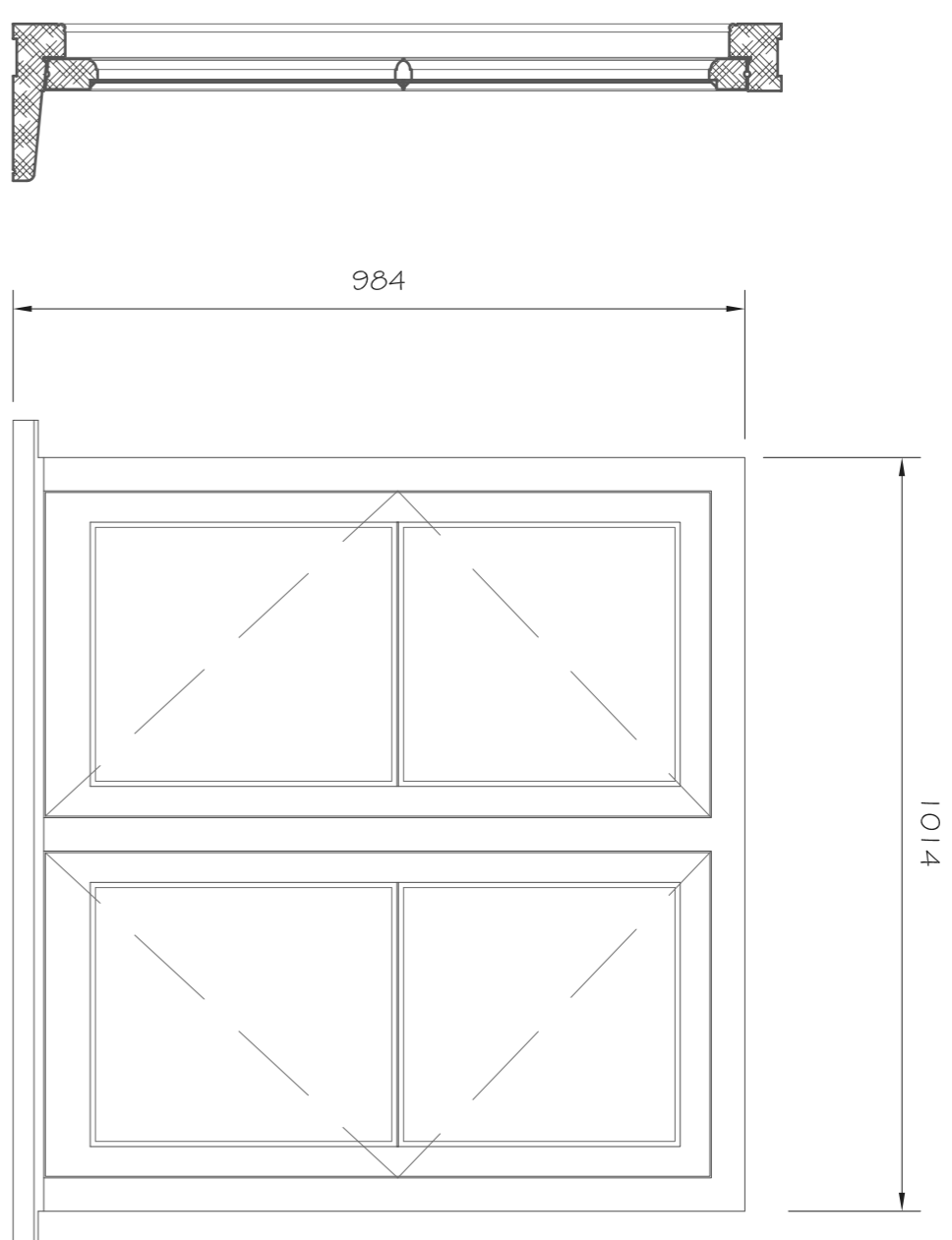

CASEMENT WINDOW [3]

Scale 1 : 10

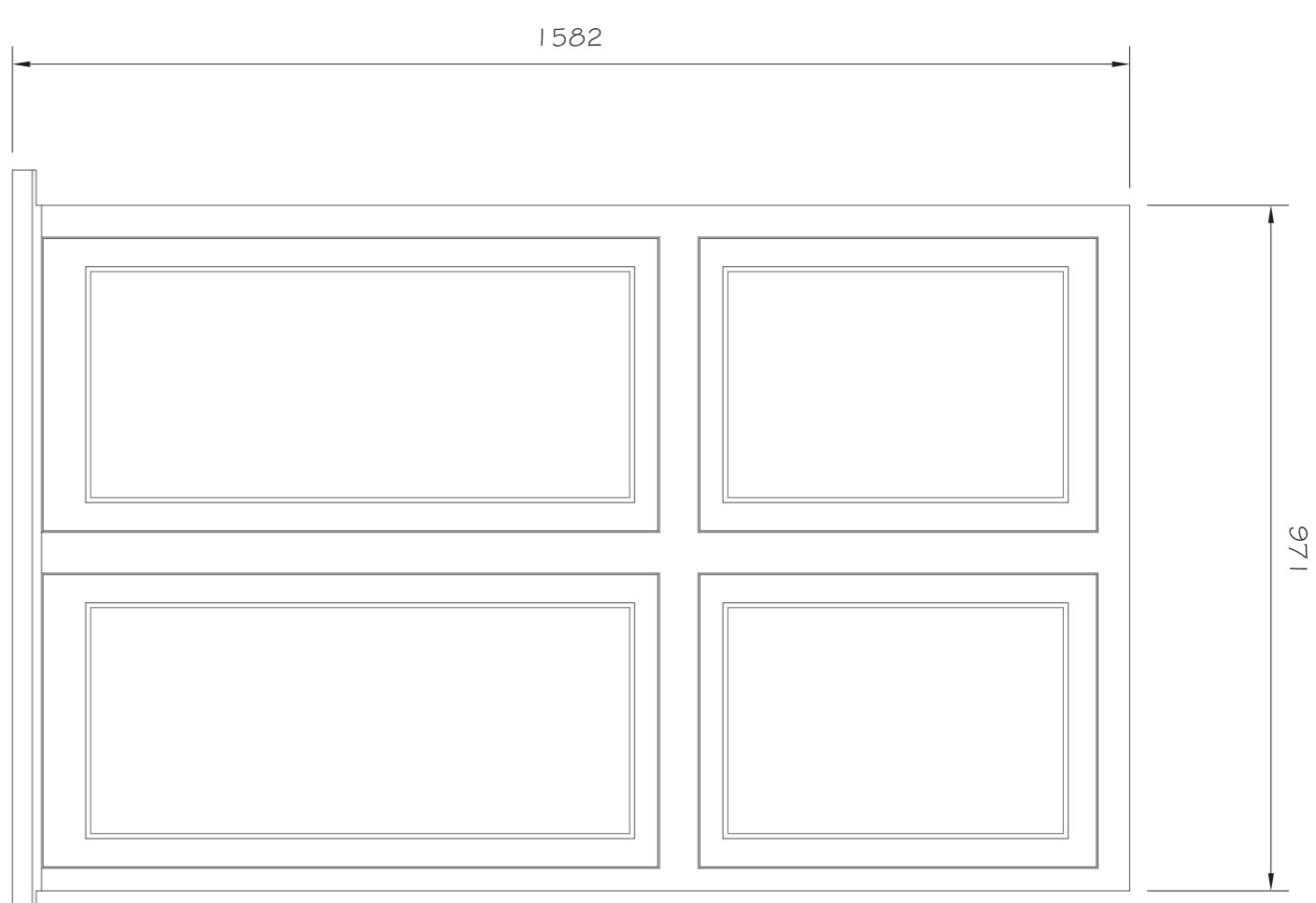

CASEMENT WINDOW [4]

Scale 1 : 10

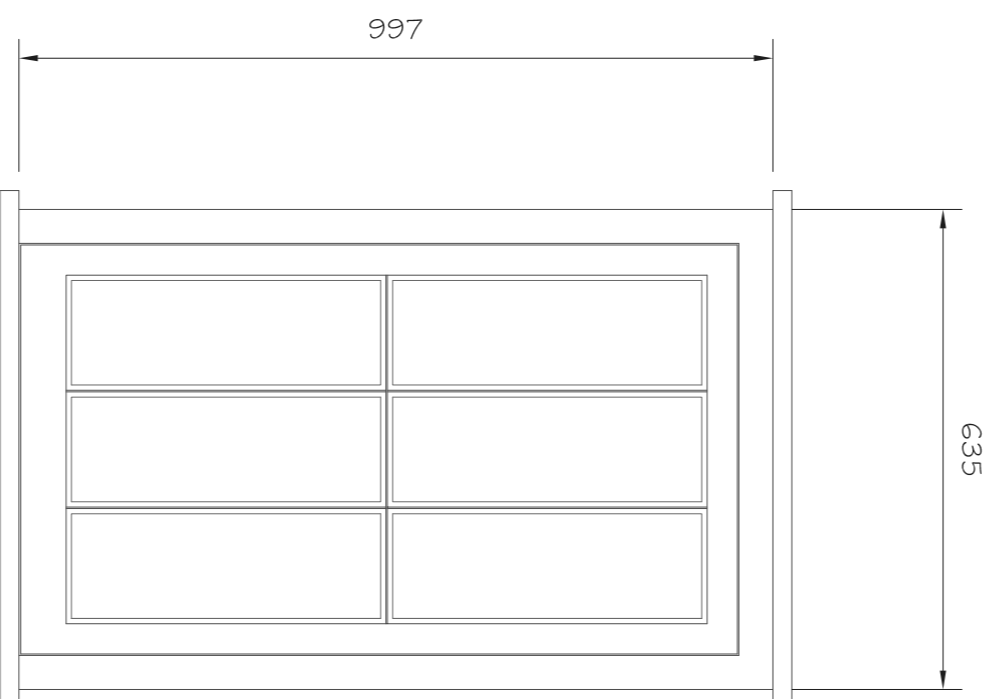
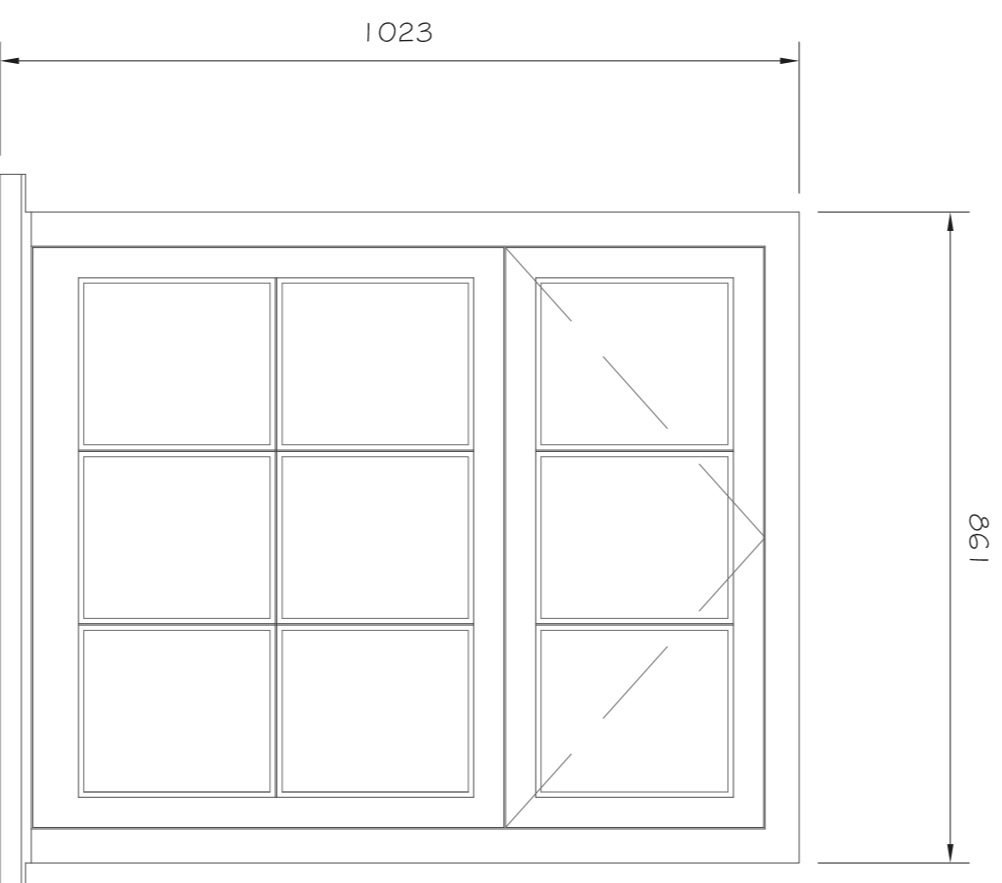

CASEMENT WINDOW [5]

Scale 1 : 10

CASEMENT WINDOW [6]

Scale 1 : 10

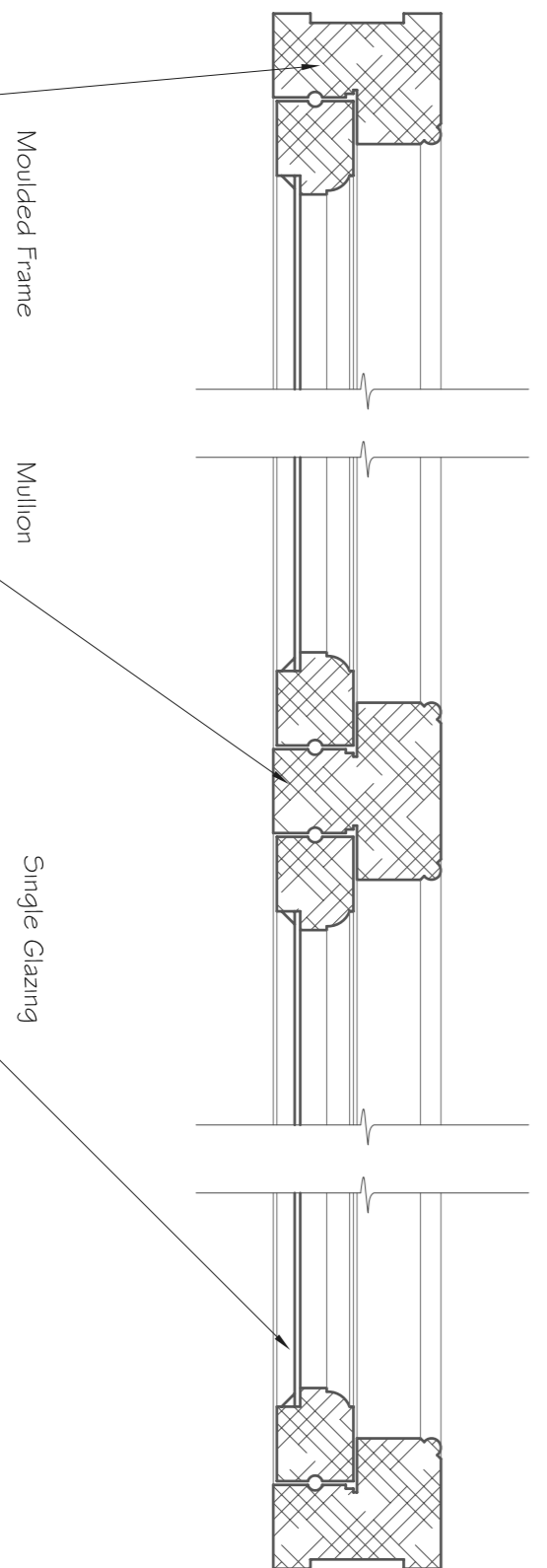

CASEMENT WINDOW

Scale 1 : 4

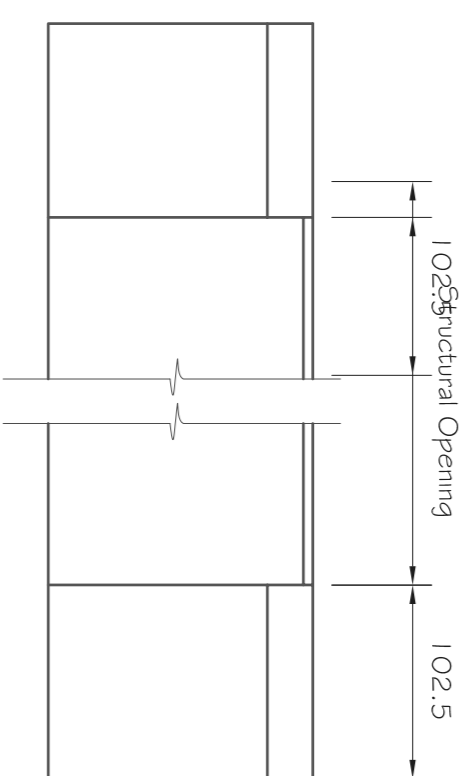

BATH STONE CILL

Scale 1 : 4

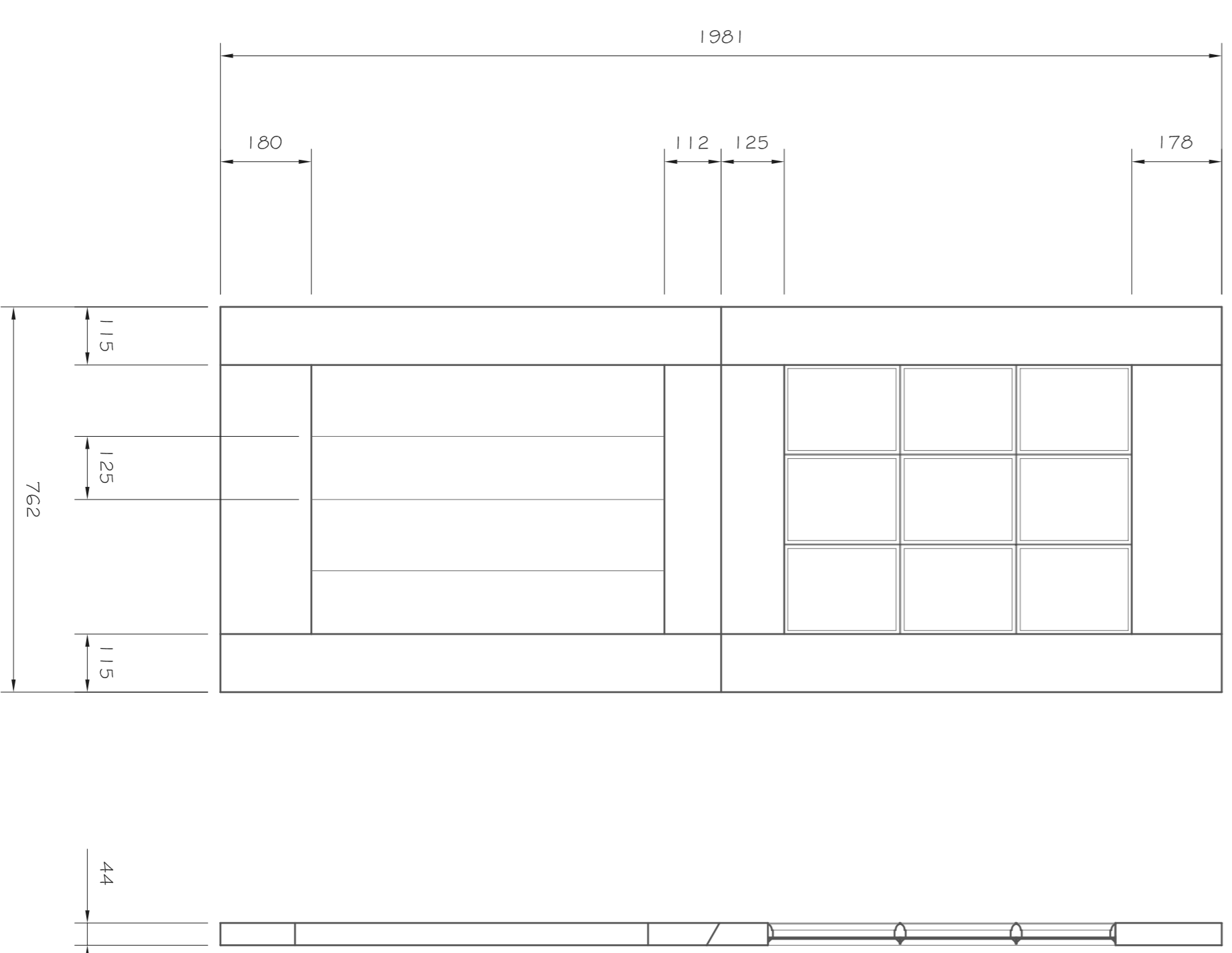
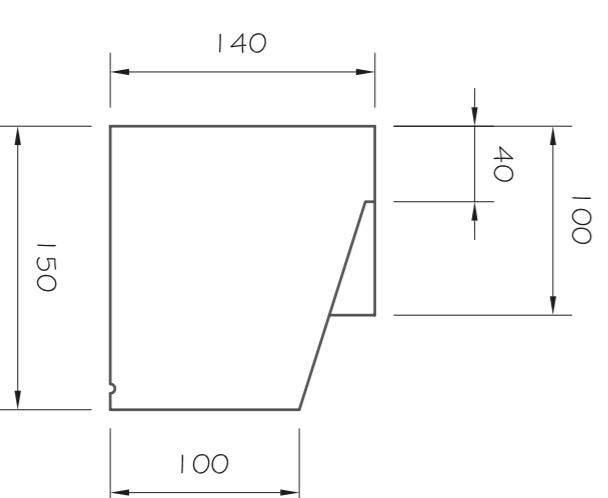

STABLE DOOR

Scale 1 : 10

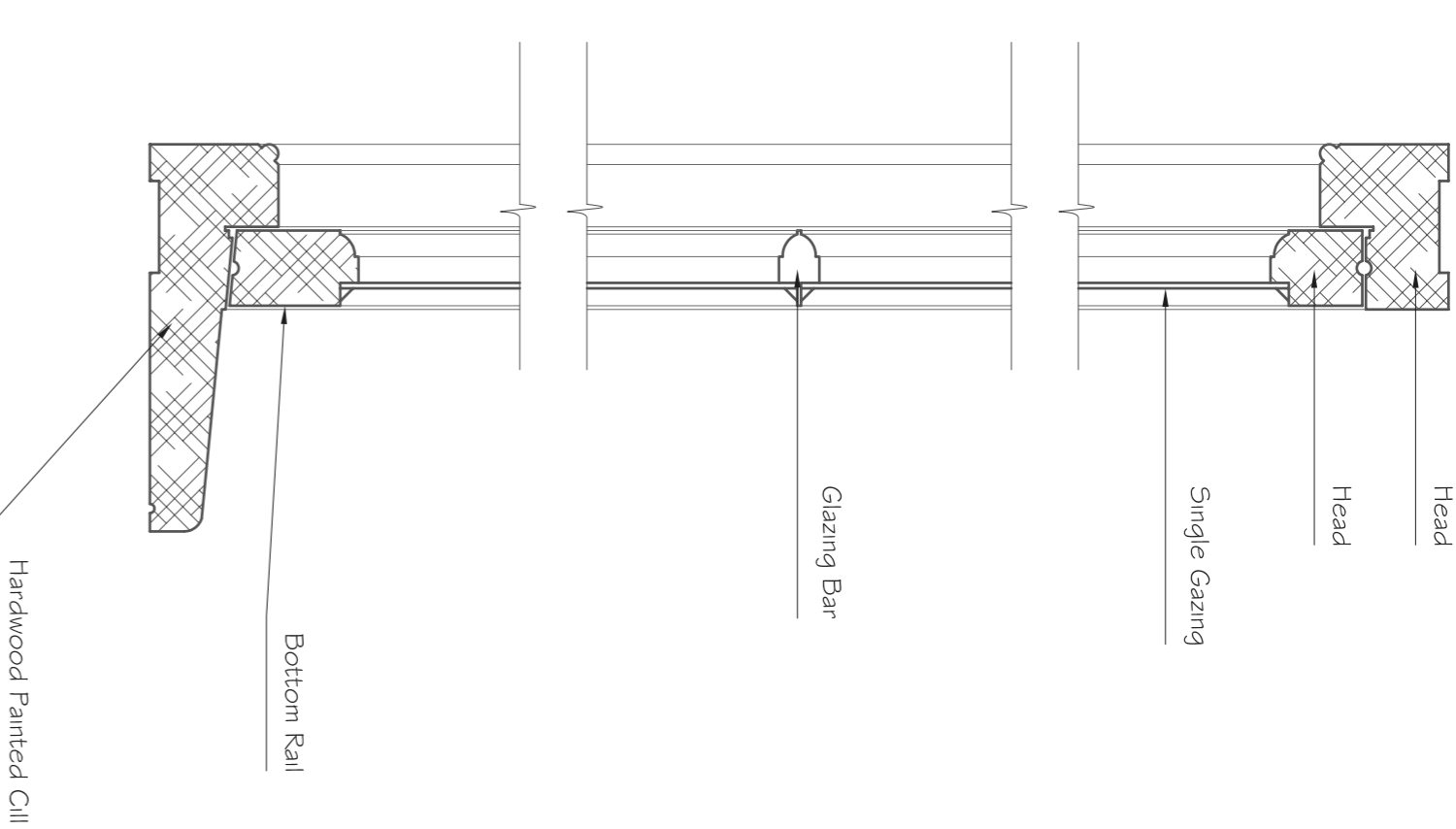

CASEMENT WINDOW

Scale 1 : 4

NOTES :

All dimensions must be checked on site and not scaled from this drawing
Original drawing size = A1
(841x594mm)

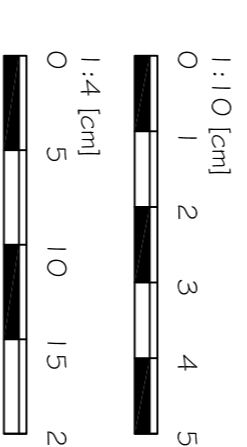

A.D. Draughting
Architectural services

Alex Dawson
www.aaddraughting.co.uk
t: 01672 517412
m: 0779 134 1689

Client MR & MRS FERGUSON

Job Title

REPLACEMENT WINDOWS AT :

ROCK HOUSE,
MILL LANE,
HAMBROOK,
BRISTOL,
BS16 1SA.

Drawing Title

CASEMENT WINDOW DETAILS
STABLE DOOR DETAILS

Scale A5 SHOWN

Date 01/11/2012 Drawn AD

Drawing No. AD-AF-003 Rev A